



SIKA SOLUTIONS FOR FACADES ASIAN LANDMARKS WITH SIKA INSIDE

BUILDING TRUST



SIKA'S FACADE SOLUTION

Sika's facade products have a long history. Sikaflex® PU sealants for concrete walls and SikaMembran® EPDM sheet membranes have long been introduced in the facade market. However before 2004 Sika was not an important player in the structural glazing facades. When Sika acquired the engineering silicone business from Wacker-Chemie GmbH in 2004, Wacker's Elastosil® SG-500 and Elastosil®-355 have already been used for more than 10 years by renowned curtain wall fabricators such as Josef Gartner and Shenyang YuanDa. Sika then composed a unique product portfolio around the silicone products, called now Sikasil®, and established a sophisticated technical service in the Sika Facade Competence in Switzerland and a very efficient on-site service. Thus Sika became THE partner for sealing and bonding in glass facades, for all climatic conditions, from the harsh Siberian winter to the hot and humid equatorial summer.

CONTENT

05	Each Facade is Different
06	Structural Glazing with Sikasil® SG and WS
07	Sikasil® Sealants Specialties
08	Argon-filled Insulating Glass with Sikasil® IG-25 HM Plus
09	Glass Wall Grouting with SikaGlaze® GG
10	Vapor Proofing with SikaMembran® System
11	Facade Cladding with SikaTack® Panel System
12	Sika Landmarks in North China
14	Sika Landmarks in East and Central China
16	Sika Landmarks in South China and Macau
18	Sika Landmarks in Taiwan
20	Sika Landmarks in Thailand
24	Sika Landmarks in Malaysia
28	Sika Landmarks in Singapore
30	Sika Landmarks in Indonesia

Front cover:
7 Harbin Opera House



EACH FACADE IS DIFFERENT SIKA HAS THE RIGHT SOLUTIONS

APPLICATIONS AND SIKA PRODUCTS MENTIONED IN THE PROJECT LISTS

SG	Structural glazing	Sikasil® SG-500 CN
WS	Weather sealing	Sikasil® WS-605 S, SikaHyflex®-305
NS	Natural stone sealing	SikaHyflex®-355
GS	Glass-to-glass sealing	Sikasil® GS-621
FS	Fire-retardant sealing	Sikasil®-670 Fire, Sikasil® FS-665 SL
MB	Water- /vapor-proofing	SikaMembran® System
IG	Insulating glass edge sealing	Sikasil® IG-25 HM Plus, SikaGlaze® IG-5 PIB
GG	Glass wall embedding	SikaGlaze® GG-735
TP	Elastic panel bonding	SikaTack®-Panel System
SF	Joint sealing of concrete	Sikaflex®, SikaHyflex® PU sealant & PU-Hybrid

The pages 6 – 11 introduce various facade products, besides common structural glazing silicone adhesives, insulating glass sealants and weather sealants. As some of the technologies have not yet been introduced to Asia, we prove our job experience with some European reference projects.

The second part shows a selection of project references in some Asian countries where Sika FFI has been active since 2004. Projects before 2004 have been realised under Wacker-Chemie. Overall we can look back on more than 8,000 projects around the globe.

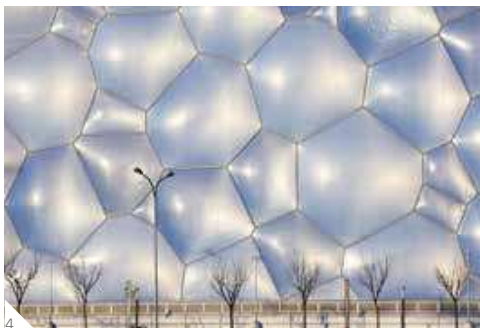

STRUCTURAL GLAZING WITH Sikasil® SG AND WS



1 PingAn IFC, Beijing, China (2007)

Architect: Beijing Institute of Architectural Design (CN)

Facade by Shenyang YuanDa (CN)

Sika Product: Sikasil® SG-500 CN

PROJECT REQUIREMENTS

In Structural Sealant Glazing UV and weathering resistant silicone adhesives and compatible weather sealants are state of the art technologies. The world's leading curtain wall fabricators requested the most durable and reliable products.

SIKA SOLUTIONS

Sika Facade Competence Centre in Switzerland has tested the adhesion and compatibility of Sikasil® SG-500 CN (complying with ASTM C1184) and the SikaHyflex®-305 (classified ASTM C920, class 50) with all materials in contact with the silicones prior to any application in these high rise buildings. For perfect compatibility Sika provides the Sika® Spacer Tape HD.

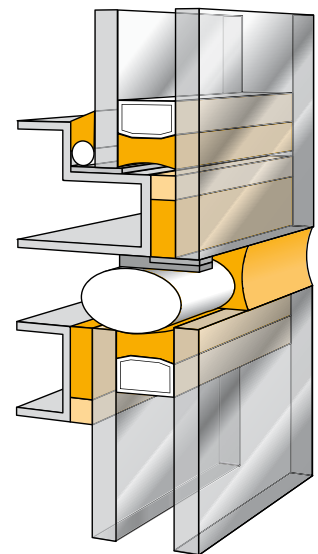

Sikasil® SEALANTS SPECIALTIES



PROJECT REQUIREMENTS

In many facades weather sealants are due to special requirements, smoke-proof in case of fire, non-staining to natural stone or even non-streaking/non-bleeding in glass and metal facades.

SIKA SOLUTIONS

Sika FFI has developed several types of sealants meeting particular requirements:

- Sikasil®-670 Fire: Fire-retardant (complying BS476, 4 hrs fire-rating)
- Sikasil® FS-665 SL: Self-levelling fire-retardant sealant (complying BS476, 4 hrs fire-rating)
- SikaHyflex®-355: Non-staining weather sealant for natural stone facades
- Sikasil® WS-605 S: Non-streaking weather sealant for glass facades and metal panels, minimised dirt pick-up
- Sikasil® GS-621: Translucent glass-to-glass sealant

68 Republic Polytechnic Centre, Singapore (2006)

Architect: Consultants Incorporated (SG)

Facade by Facade Master (SG)

Sika Products: Sikasil® WS-605 S; Sikasil® SG-500 CN

3 Pangu Plaza, Beijing (2008)

Architect: C.Y. Lee & Partners (CN)

Facade by Shanghai Huayi (CN)

Sika Product: SikaHyflex®-355

9 Greenland Luwan Riverside CBD, Shanghai (2010)

Architect: Callison LLC, USA

Facade by Shenyang YuanDa (CN),

Shanghai Meite, Suzhou Gold Mantis (CN)

Sika Product: Sikasil® GS-621

ARGON-FILLED INSULATING GLASS WITH Sikasil® IG-25 HM PLUS



61 Russia Federation Towers, Moscow (2008)
Architects: Tschoban & Schwegler (DE)
Facade by Shenyang YuanDa (CN)
Insulating Glass by SYP (CN)



6 Nou Hotel Beijing (2014)
Facade by Jangho, (CN)
Insulating Glass by SYP (CN)

PROJECT REQUIREMENTS

In high-performance energy-saving glass facades the insulating glass units must be argon-filled, especially in cold climates. So far this was the domain of capped wall systems and standard windows with PU and PS secondary sealants, because for structural sealant glazing only silicone sealants are approved. But due to the high argon permeability they were regarded as not suitable for argon-filled IG units.

SIKA SOLUTIONS

With the development of the high-modulus silicone secondary sealant Sikasil® IG-25 HM Plus argon loss rates as low as 0.2% per year are achievable, resulting in a service life of the IG unit of at least 30 years.

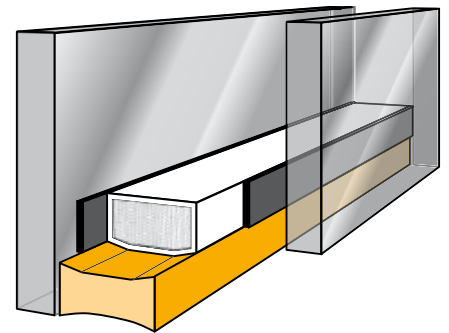

GLASS WALL GROUTING WITH SikaGlaze® GG



62 Riverbank House, London (2011)
Architect: David Walker Architects (UK)
Facade and balustrades by Josef Gartner (DE)



63 MahaNakhon, Bangkok (2016)
Architect: Office for Metropolitan Architecture OMA (NL)
Balustrades by Peterson (TH)

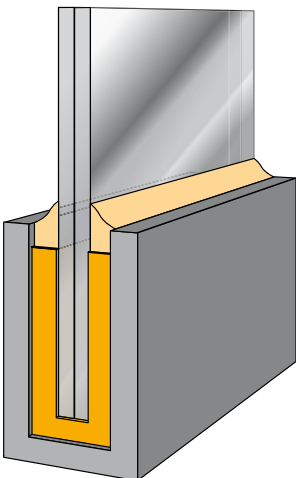

PROJECT REQUIREMENTS

Glass balustrades should be fixed to the floor with the lowest possible stress to the glass pane. But mechanical fasteners transfer high punctual stress to the glass. Thicker glass panes are the consequence.

SIKA SOLUTIONS

The bottom glass edge is embedded in the floor with self-levelling, high-strength fast-curing 2-part PU system SikaGlaze® GG-735, resulting in uniform stress distribution and in an enormous reduction of punctual stresses. The PU embedding is protected against weathering by Sikasil® WS/SikaHyflex®.

VAPOR PROOFING WITH SikaMembran® SYSTEM



64
64 Adia, Abu Dhabi (2004)
Architect: Kohn Pederson Fox Associates (US)
Facade by Schmidlin AG (CH)



8
8 Park View Green Plaza, Beijing (2010)
Consultant: ARUP Hong Kong
Facade by Beijing Jianli (CN)



65 5 Aldermanbury Square, London (2005)
Architect: Eric Parry Architects (UK)
Facade by Lindner-Schmidlin UK

PROJECT REQUIREMENTS

The 3 projects on this page either have a very fragmented facade with protrusions or connections between facades where joint sealing with wet sealants is not possible and wide gaps have to be water-/vapor-proof.

SIKA SOLUTION

The SikaMembran® system consists of a set of EPDM membranes and an adhesive suitable for a durable water-/vapor-proofing in each climate and on many various substrates. The fast and easy application of the thin sheet membranes is outstanding.

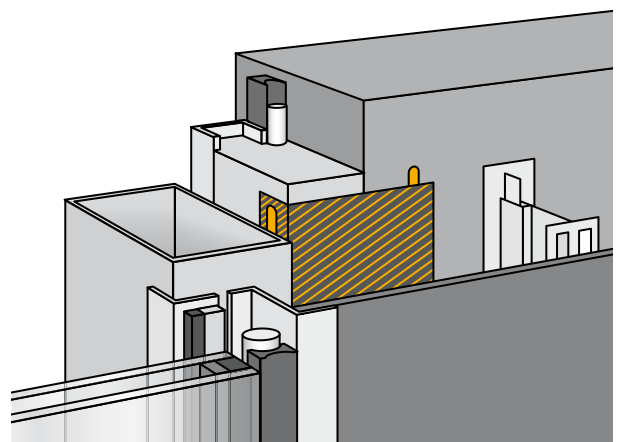

FACADE CLADDING WITH SikaTack® PANEL SYSTEM



66
66 Lifelong Learning Centre, Barking, UK
Architect: Allford Hall, Monaghan Morris (UK)
Facade by Cladding UK



67
67 Threshold Residential, Parsons Green, London
Client: Threshold Housing Association (UK)
Facade by Cladding UK

PROJECT REQUIREMENTS

For these projects, the contractors required a striking white all over aesthetic flawless facade without a single fastener to diminish the appearance.

SIKA SOLUTION

SikaTack® Panel elastic bonding technology requires no screws or brackets and grants a timesaving application. Temporarily held in place using special double-sided tape, SikaTack® Panel adhesive bonds the panel firmly but stress free to the carrier frame (no buckling). Vapor proofing of the ventilated facade ideally is done with SikaMembran® system.

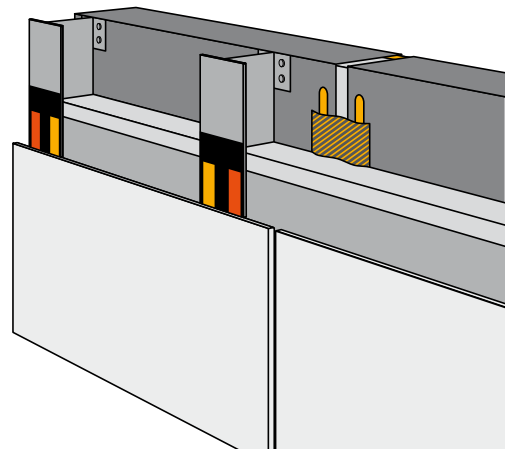



SIKA LANDMARKS IN NORTH CHINA



2



3



5



4

No	Project Name, Location	Facade Manufacturer	Architect, Consultant	Year	Sika Products
1	PingAn International Financial Centre, Beijing, Yansha Bridge	Shenyang YuanDa	A) Beijing Institute of Architectural Design	2007	SG, WS, NS
2	International Finance and Economy Centre, Beijing, Huayuan Bridge	Shenyang YuanDa	A) Rocco Design, Hong Kong	2007	SG, WS, GS
3	Pangu Plaza, Beijing, 27 Central North, 4th Ring Road	Shanghai Huayi	A) C.Y. Lee & Partners Architects & Planners	2008	SG, WS, NS, FS, GS
4	National Swimming Centre (Water Cube), Beijing Olympic Park	Shenyang YuanDa	A) State Construction Engineering Corp., PTW Architects, Australia C) Arup, Australia	2008	WS, GS
5	Jinghang Plaza, Beijing, Tongzhou Distric	Dongfang Taiyang	A) GOA Architects C) Meinhardt Facade Engineering	2015	SG, WS
6 Page 5	Nuo Hotel Beijing, 2A Jiangtai Road, Chaoyang District	Jangho		2014	SG, WS, IG
7 Page 5 Cover	Harbin Opera House	Shenyang YuanDa	A) MAD Architects C) Inhabit Group, China Jingye Engineering	2014	SG, WS, IG
8 Page 10	Park View Green Plaza, Beijing- No. 8 East Bridge Road, Chaoyang District	Beijing Jianli	A) and C) Arup, Hong Kong	2010	SG, WS, GS, FS, MB

SIKA LANDMARKS IN EAST AND CENTRAL CHINA



9



14



10



11



12



13



15



16

No	Project Name, Location	Facade Manufacturer	Architect, Consultant	Year	Sika Products
9	Shanghai Greenland Luwan Riverside CBD, Xuhui District	Shenyang Yuanda Shanghai Meite Suzhou Gold Mantis	A) Callison LLC, (US)	2010	SG, WS, NS, FS, GS
10	No.1 Suzhou River, Shanghai, 638 Hengfeng Road	Shanghai Meite	A) KFS Architects, (CA)	2010	SG, WS, NS
11	Genway Tower, Suzhou	Shanghai Meite	A) Goettsch Partner (US)	2006	SG, WS
12	Raffles City, Hangzhou	Yuanda, Taiwan Glass	A) UNStudio (NL) C) Meinhardt (CN)	2014	SG, WS, IG
13	South Commercial Center, Shanghai	Yuanda, Jangho, Hengfa	C) ARUP (CN)	2015	SG, WS, IG
14	Cloud Nine Plaza Shanghai, No. 1018 Changning Road	Shanghai Meite	A) Arquitectonica, (US)	2006	SG, WS, GS
15	Shanghai National Convention & Exhibition Center	Hongyi, Jiayu, Dimeng, Minmetals, CSCEC	C) C.E.D. Hejia	2014	WS, GG
16	Suzhou Culture and Arts Centre, Suzhou- Jinji Lake	Shenyang Yuanda	A) Paul Andreu Arch. (FR)	2008	SG, WS
17	Shanghai Greenland Group Headquarters Office Building	Shanghai Meite	C) Shanghai Design Institute	2010	SG, WS, NS, FS, GS
Page 5	Bund 596, Shanghai	Wuxi Hengfa	A) Foster and Partners (UK)	2015	SG, WS
	Shanghai First People's Hospital Songjiang Branch, No. 650 New Songjiang Road	Shanghai King Burg Decoration Engineering		2008	SG, WS, NS, FS, GS
	Jinghope Intercontinental Hotel Suzhou, Jinji Lake	Shenyang YuanDa	A) East China Architectural Design & Research Institute	2009	SG, WS, NS
	The Longemone Hotel Shanghai, No. 1116 Yan An Road West, Changning District	Shanghai Meite	A) Arquitectonica, USA East China Architectural Design & Research Institute	2005	SG, WS
	Shanghai Greenland Centre, Xuhui District	Shanghai New Century Suzhou Gold Mantis	C) Shanghai Design Institute	2011	SG, WS, NS, FS, GS
	Shanghai Pujiang Int. Financial Plaza	Shenyang YuanDa, SYP	C) ARUP, Shanghai	2014	SG, IG, WS
	Hotel Nikko Suzhou	Gold Mantis, Suxin	C) MOF, Hongkong	2014	SG, WS

SIKA LANDMARKS IN SOUTH CHINA AND MACAU



18

19



20



21



22



23

No	Project Name, Location	Facade Manufacturer	Architect, Consultant	Year	Sika Products
18	China Huarong Tower, Zhuhai	Zhejiang Zhongnan		2015	SG
19	Shenzhen Energy Group Headquarter, Shenzhen	Shenzhen Fangda		2015	SG, WS, IG
20	The Parisian Macao	Macao SingYes Renewable Energy Technologies	A) Gensler, Aedas, AECOM C) Meinhardt Facade	2016	SG, WS, GG, SF
21	Shenzhen TV Center, Shennan Road, Futian District	Shenzhen Sanxin	A) Chongqing University Institute of Architectural and Design	2004	SG, WS, GS
22	Guangdong Development Bank, Zhujiang New Town, Guangzhou	Shenyang YuanDa	A) GMP Architects, (DE) Guangzhou Design Institute	2005	SG, WS, NS, GS
23	MGM Cotai Hotel, Macau	Minmetals Condo	A) KPF (US) Wong & Tung	2017	SG, WS
	Shenzhen Noble Financial Center, No.1006 3rd Fuzhong Road	Shenyang YuanDa	A) TEP UK, Shenzhen Fangjia Architecture Design	2006	SG, WS
	Shum YIP Upper Hill, Shenzhen	Sanxin, CSCEC 3rd Bureau, Lijin		2015	WS



SIKA LANDMARKS IN TAIWAN



25



26



27

No	Project Name, Location	Facade Manufacturer	Architect, Consultant	Year	Sika Products
24	China Steel HQ, Kaohsiung City	CWCO	A) ARTECH INC	2011	SG, WS, NS
25	World Games 2009, Kaohsiung City	San Unity	A) Toyo Ito & Associates	2008	SG
26	Chang Jung Health and Culture Village Building E of Area C, Taoyuan County	TAB	A) Ricky Liu & Associates Architects + Planners	2007	SG, WS, NS
27	Taipei Dome Complex (Taipei)	TAIWAN I-CHUAN Engineering		2017	SG, WS, NS
	Art Performing Center(Taipei)	Taibei Zhenzhan		2015	GG
	Chiayi Chang Jung Memorial Hospital of the C.G.M.F, Chiayi County	TAB	A) Ricky Liu & Associates Architects + Planners	2008	SG, WS, NS
	Taichung City Government Building	San Unity	A) Weber+Hofer AG Architects	2010	SG, WS, NS
	Taipei Far Eastern Telecom Park, New Taipei	Kikukawa	A) ARTECH INC	2010	SG, WS
	QinMeiPuJen, Taipei City	CWCO		2010	SG, WS, NS
	HongHer Office, New Taipei City	JingQuan		2010	SG, WS
	FE21 in Banqiao District, New Taipei City	Kikukawa	A) ARTECH INC C) Origin Design & Engineering	2011	SG, WS, NS
	FE21 in Taichung City	Kikukawa	C) Origin Design & Engineering	2011	SG, WS, NS
	03, Taipei City	WanSin Alu.	C) Origin Design & Engineering	2012	SG, WS, NS

SIKA LANDMARKS IN THAILAND



29



30



31



32

No	Project Name, Location	Facade Manufacturer	Architect, Consultant	Year	Sika Products
28	Energy Complex, Viphawadee Road	Kama Group	A) Architects 49	2010	SG, WS
29	Cyber World, Ratchadapisek Road	Kim Yoo Seng	A) Robert G. Boughey & Associates	2009	SG, WS
30	Grand Millennium Sukhumvit, Bangkok	Pacific Window	A) Palmer & Turner, (TH)	2007	SG, WS
31	Rangsit University, Muang-Ake, Phaholyothin Road, Bangkok	P.K. Aluminium	A) Faculty of Architecture, Rangsit University	2008	SG, WS
32	Sala @ Sathorn	Kim Yoo Seng	A) Hassell, Thailand	2009	SG, WS
	Kasikorn Bank, Popular Street, Muangthong	Kim Yoo Seng	A) Design 103 International	2010	SG, WS
	Ideo Condominium, Onn-nuh Road, Bangkok	P.K. Aluminum	A) Westcon	2011	SG
	The Star Estate, Rama III Road, Bangkok	Alumayer (Thailand)	A) Maps Design Studio C) Arun Chaiseri Cons. Eng.	2007	SG, WS
	The Park Chidlom, Chidlom Road, Bangkok	Alumayer (Thailand)	A) Palmer & Turner (TH)		SG, WS
	East Water, Viphawadee Road, Bangkok	Pacific Window	A) CASA	2009	SG, WS
	The World Medical Centre, Chaengwatana Road, Bangkok	Kama Group	A) Real Estate Planning Consultants	2011	SG, WS
	The Oriental Residence, Wireless Road, Bangkok	Kim Yoo Seng	A) DB Studio	2011	SG, WS



SIKA LANDMARKS IN THAILAND



34



35



36

No	Project Name, Location	Facade Manufacturer	Architect, Consultant	Year	Sika Products
33	Magnolias, Ratchadamri Boulevard, Bangkok	Asia Aluminum & Glass	A) The Beaumont Partnership C) Meinhardt Facade	2016	SG, WS
34	Metropolis Sukhumvit 39, Bangkok	Pacific Window	A) Palmer & Turner (TH) C) Northcroft (TH)	2015	SG, WS
35	Osotspa, Ramkhamhang Rd., Bangkok	Asia Aluminum & Glass	A) Plan Architect C) Arun Chaiseri Cons. Eng.	2015	SG, WS
36	Equinox, Vibhavadi-Rangsit Rd, Chatuchak	Diamond Golden Glass	A) Palmer & Turner (TH) C) Focus Developm. & Constr.	2014	SG, WS
63	MahaNakhon, Narathiwat Ratchanakharin Road, Bang Rak	Peterson	A) Office for Metropolitan Architecture OMA (NL), Palmer & Turner (TH) C) 1990 Co.	2016	GG
	Aloft Hotel	Pacific Window	A) Inter Akitek C) InterPac	2012	SG, WS
	Bangkok Metropolitan Administration Phase 2	Asia Aluminum & Glass		2013	SG, WS
	Bright Sukhumvit 24		A) Inter Akitek C) InterPac	2012	SG, WS
	Central Plaza West gate	Asia Aluminum & Glass	A) AMA Design Studio	2015	SG, WS



SIKA LANDMARKS IN MALAYSIA



38



39



40

No	Project Name, Location	Facade Manufacturer	Architect, Consultant	Year	Sika Products
37	Menara Bank Islam (Menara Wakaf), Jalan Perak, Kuala Lumpur	Puspajaya Aluminium	A) RSP Architects C) Pintar Jaya Consultant	2011	SG, WS
38	Menara Felda, Platinum Park, Kuala Lumpur	Angkasa Jasa	A) RSP Singapore C) Meinhardt Facade	2012	SG, WS
39	Ilham Baru Tower, Jalan Binjai, Kuala Lumpur	PMB Facade	A) Foster & Partner, GDP Architects C) Meinhardt Facade	2015	SG, WS
40	KL Sentral Lot-G (NU Sentral)	Puspajaya Aluminium	A) GDP Architects C) Fenestra Malaysia	2014	SG, WS
41	HSBC Headquarters Annexe (Quill 6), Leboh Ampang, Kuala Lumpur	CML	A) Micheal Ong Chartered Architect	2010	SG, WS
Page 2	Ministry of Housing & Local Government (Putrajaya 4G10), Precint 4, Putrajaya	Suncon - Central Glass JV	A) MAA Architects C) Arup Singapore	2011	SG, WS
	Ministry of Rural Development (Putrajaya 4G8)	Puspajaya Aluminium	A) Juhari & Hashim Chartered Architects C) Pintar Jaya Consultant	2011	SG, WS
	One First Avenue, Bandar Utama, Petaling Jaya	United Tai Weng Engineering	A) CT Architect	2010	SG, WS
	The Shell Business Service Centre, Cyberjaya	CML	A) Michael Ong Chartered Architect	2010	SG, WS

42 Kompleks Kerja Raya 2,
Jalan Sultan
Salahudin, Kuala Lumpur



SIKA LANDMARKS IN MALAYSIA



43



44



45



46



47

No	Project Name, Location	Facade Manufacturer	Architect, Consultant	Year	Sika Products
42	Kompleks Kerja Raya 2, Jalan Sultan Salahudin, Kuala Lumpur	Puspajaya Aluminium	A) GDP Architects C) Fenestra Malaysia	2013	SG, WS
43	Tabung Haji @ Putrajaya (Jakim)	Fujisash	A) RSP Architects C) Pintar Jaya Consultant	2015	SG, WS
44	Putrajaya 4G5	Puspajaya Aluminium	A) MAA Architects C) Meinhardt Facade	2014	SG, WS
45	Putrajaya 2C10	Puspajaya Aluminium	A) aQidea Architects C) Meinhardt Facade	2014	SG, WS
46	Dialog HQ	Metal Works	A) SAA Architects C) Pintar Jaya Consultant	2014	SG, WS
47	Sasana Kijang (Bank Negara Financial Services Resource Centre), Jalan Dato' Onn, Kuala Lumpur	HKL Metal Works	A) Hijjas Kasturi Associates C) ARUP Singapore	2011	SG, WS
	IOI Puchong Financial Ctr (twr 4 & 5)	Angkasa Jasa	A) MAA Architects	2013	SG, WS
	Paradigm City, Mall, Tower A, B, D & E	HKL Metal: Mall, Tower A, E Facade Treatment Engineering: Tower B, D	A) RSP Architects C) Pintar Jaya	2012 - 2017	SG, WS
	Menara Public Mutual	Puspajaya Aluminium	A) MAA Architects C) Meinhardt Facade	2015	SG, WS

SIKA LANDMARKS IN SINGAPORE





No	Project Name, Location	Facade Manufacturer	Architect, Consultant	Year	Sika Products
48	One Marina Boulevard (NTUC Centre), Shenton Way	Facade Master (SG)	A) DP Architects C) Connell Wagner	2004	SG, WS, GS
49	The Edge on Cairnhill, Cairnhill Rd	Permasteelisa		2002	SG, WS, NS
50	High Street Centre A&A, Boat Quay	YKK AP Singapore	A) Consultants Incorporated Architects + Planners C) Connell Wagner	2004	SG, WS, GS
51	La Salle College of the Arts, Prinsep Street	Shenyang YuanDa	A) RSP Architects	2007	SG
52	268 Orchard Road	Amxon Steel	A) Raymond Woo & Ass. Architects	2014	WS
53	Standard Chartered Bank, Changi Business Park	Shenyang YuanDa	(A) ADDP Architects	2009	SG, WS
68 Page 7	Republic Polytechnic Centre	Facade Master (SG)	Consultants Incorporated Architects + Planners	2009	SG, WS
	Seagate @ Woodlands Ave 12	Colt Ventilation	A) 3 HP Architects	2007	SG, WS, GS
	Singapore IBM Building @ Changi Business Park	Shenyang YuanDa	A) Chin Kam	2003	SG, WS, GS
	Wisma Atria (podium) A&A, Orchard Rd	Facade Master (SG)	A) DP Architects C) Arup Singapore	2003	SG, WS
	The New Supreme Court	Facade Master (SG)	A) Foster & Partner; CPG	2004	SG, WS
	Monetary Authority of Singapore Bldg (MAS Bldg) A&A, 10 Shenton Way	Facade Master (SG)	A) RSP Architects C) Arup Singapore	2005	SG, WS
	43 Macpherson Road	Hong Yang Alum	A) Swan and Maclaren	2015	WS
	Archipelago	Merdeka construction	A) Ong & Ong F. Consultant	2014	MB
	Corals by Keppel bay	Jangho Curtain Wall	A) Daniel Libeskind	2016	MB
	E9 Premium	AES Facade	A) ID Architects	2015	SG, WS
	Hotel Indigo Katong	Keyon Construction	A) SCDA Architects	2016	SG, WS
	Rivera 38	Merdeka construction	P & T Consutants	2014	MB
	LF Logistics @ Bulim	AES Facade	A) Daniel Libeskind	2015	WS

SIKA LANDMARKS IN INDONESIA





58



59



60

No	Project Name, Location	Facade Manufacturer	Architect, Consultant	Year	Sika Products
54	Allianz Tower	Pt. Indalex	A) Pt Duta Cermat Mandiri	2010	SG
55	Tempo Scan	Pt. Indalex	A) Pt Graha Cipta Hadiprana C) Aurecon	2010	SG
56	Rasuna Tower, Jakarta	Pt. Indalex	A) A) Sekawan Design Inc C) DSI	2015	SG, WS
57	Landmark Pluit, Jakarta	Pt. Indalex	A) Pt. Airmas Asri	2015	SG, WS
58	One Pacific Place, Jakarta Kawasan SCBD	Pt. Indalex	A) Pt. Airmas Asri	2008	SG, WS
59	The Thamrin Nine (UOB Bank), Jakarta, Jl. MH. Thamrin,	Pt. Indalex	A) Pt. Duta Cermat Mandiri C) Connel Wagner	2009	SG, WS
60	Chase Tower, Jakarta	CML SB	A) Duta Anggada Realty C) DSI	2015	SG, WS
	Equity Tower, Jakarta	Pt Indalex	A) Pt Airmas Asri C) Pt HRT	2009	SG
	Bakrie Tower, Jakarta, Jl. Jend Sudirman	Pt Indalex	A) Urbane Indonesia C) Connel Wagner; Meinhardt Facade	2009	SG, WS
	Paragon, Semarang, East Java	Pt Indalex	A) PTI Architect C) Aurecon	2010	SG
	Darmawangsa Condo	Pt Indalex	A) Pt Kiat Arsindo	2011	SG, WS

GLOBAL BUT LOCAL PARTNERSHIP



WE ARE SIKA

Sika is a specialty chemicals company with a leading position in the development and production of systems and products for bonding, sealing, damping, reinforcing and protecting in the building sector and the motor vehicle industry. Sika's product lines feature concrete admixtures, mortars, sealants and adhesives, structural strengthening systems, industrial flooring as well as roofing and waterproofing systems.

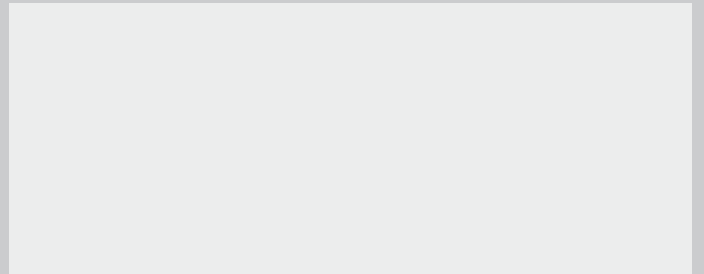

Our most current General Sales Conditions shall apply. Please consult the most current local Product Data Sheet prior to any use.



SIKA SERVICES AG
Tueffenwies 16
CH-8048 Zurich
Switzerland

Contact
Phone: +41 58 436 40 40
Fax: +41 58 436 55 30
E-mail: wagner.werner@ch.sika.com
www.sika.com/ses

BUILDING TRUST

